

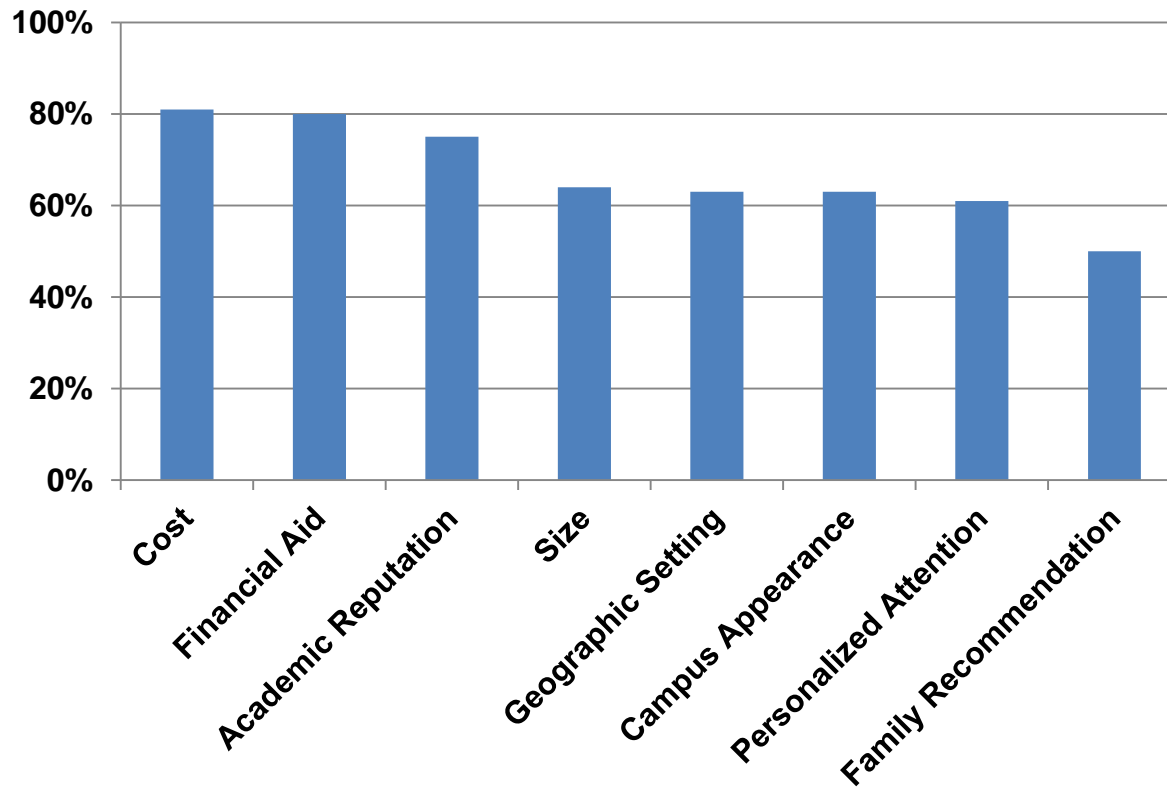

THE UNIVERSITY OF
ALABAMA IN HUNTSVILLE

Scholarship Reception
October 23, 2014

**Important or Very Important
to Enroll: 4-Yr Public, First-Year***



Other Factors*

- Employment opportunities
- Opportunity to play sports

* National Research Report, Noel-Levitz, 2012



THE UNIVERSITY OF ALABAMA IN HUNTSVILLE

ABOUT UAH EVENTS MAP GIVING ALUMNI DIRECTORY

I AM A...



SEARCH



THE UNIVERSITY OF ALABAMA IN HUNTSVILLE

Admission & Aid

Academics

Research

Campus Life

Athletics

News

THE UNIVERSITY OF ALABAMA IN HUNTSVILLE
FALL ISSUE 2014

GAME ON

UAH debuts gaming and entertainment arts program

Check out the new Fall 2014 issue of the UAH Magazine



UAH introduces new College of Education



76
degrees offered*

80+
areas of study



UAH announces addition of lacrosse program



- Apply
- Visit Us
- Request Info

<http://www.uah.edu/>

COST VS VALUE*

#1 ROI of any Alabama institution (in-state and out-of-state)

#1 Early Career Salary of graduates from any Alabama institution

#4 ROI (in-state) in Central South (TX, OK, AR, LA, MS, AL, TN, KY)

* Payscale.com

MOVE TO BLOCK TUITION

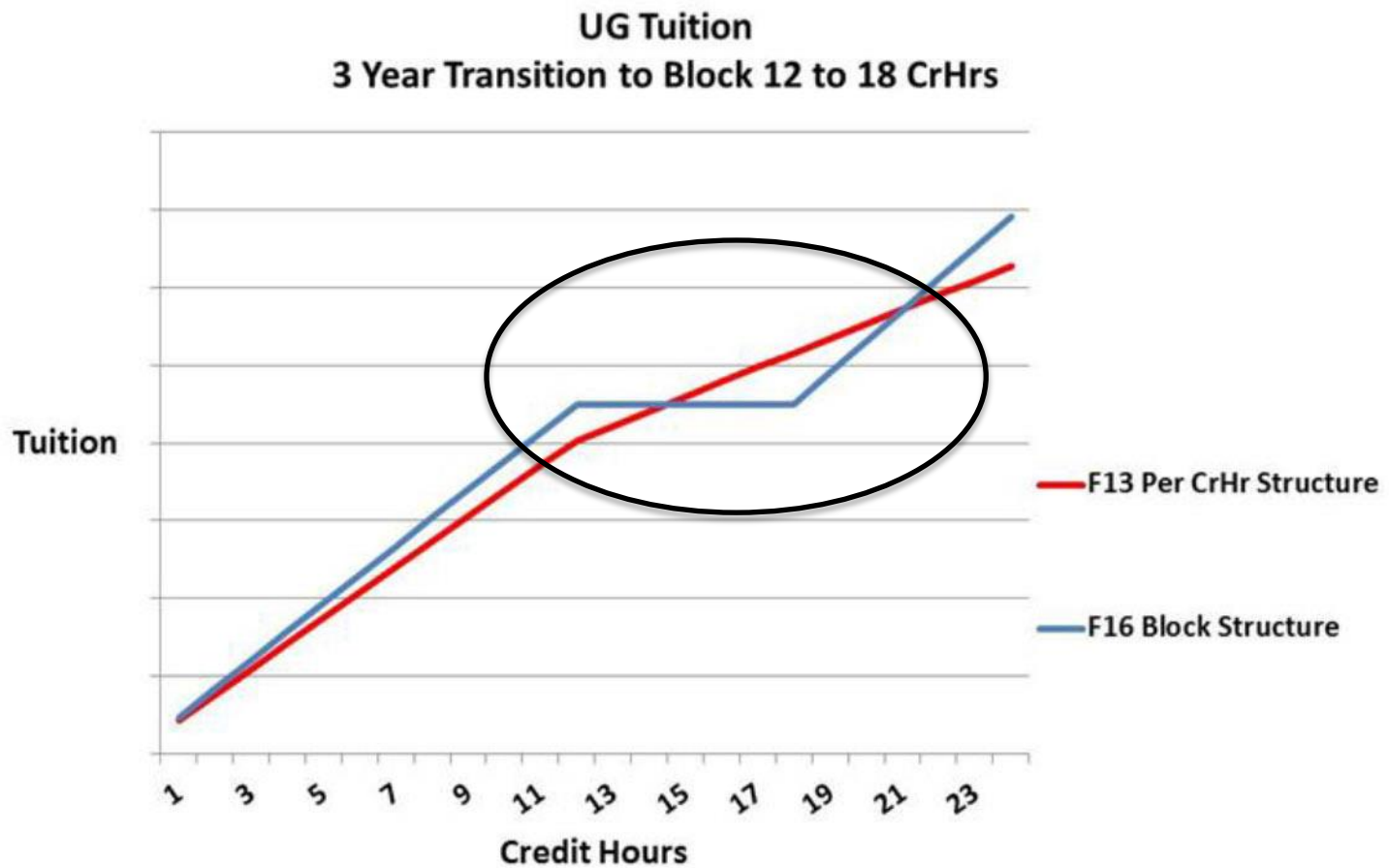

MOVE TO BLOCK TUITION

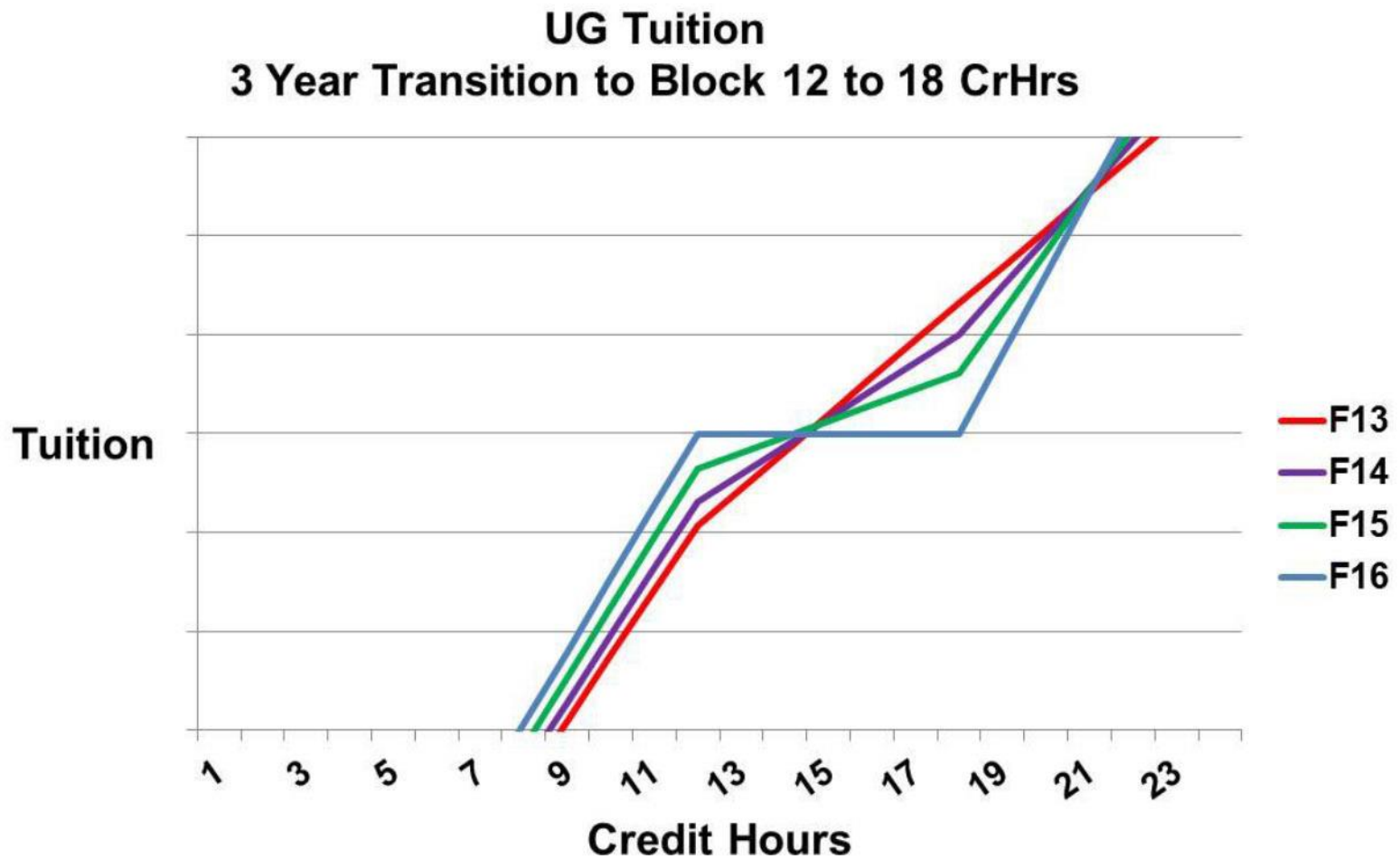

FINANCIAL AID

- Merit Tuition Scholarships

TEST SCORES	ACT	25 – 27	28 – 29	30 – 33	34 – 36
	SAT	1130 – 1240	1250 – 1320	1330 – 1480	1490 – 1600
HIGH SCHOOL GPA	4.0+	50%	67%	100%	100%
	3.50 – 3.99	40%	45%	100%	100%
	3.00 – 3.49	35%	35%	45%	50%

Charger Excellence**
Charger Distinction
Charger Scholar
Charger Achievement

FINANCIAL AID

- Private scholarship funds
 - AY13-14 to AY 14-15
 - spending ↑9.4%
 - #students receiving support ↑6%
 - Past four years awards total \$6.4 million
- Federal Financial Aid

HONORS COLLEGE

- Delivers an elite college education with research and career networking opportunities in Alabama's high-tech center
- Offers a residence hall community of Honors students who enjoy dedicated activities, study rooms, and common spaces
- Priority registration allows easier building of schedules
- Requirements: GPA of 3.5+ (unweighted), ACT of 28 or SAT of 1200, essay, involvement in organizations



COLLEGE OF EDUCATION (in progress)

- B.S. Elementary Education
- B.S. in Secondary Education/Disciplinary B.S.+Certification
- B.S. in Kinesiology (in progress)
- Proposed program: Special Education/Early Education
- UAH Rise School





THE UNIVERSITY OF
ALABAMA IN HUNTSVILLE

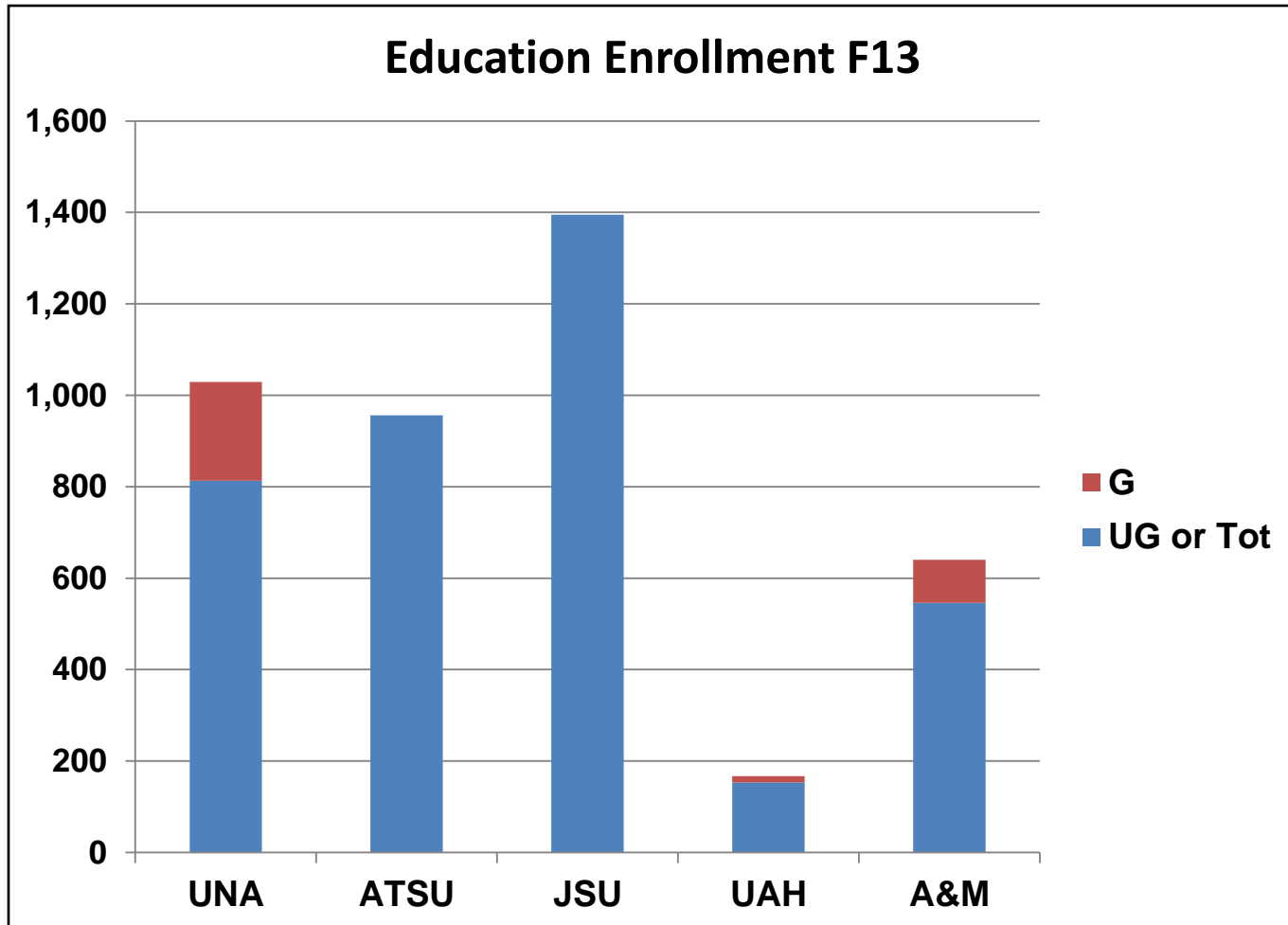

Programmatic

- Department of Space Science (2013)
 - MS, PhD Space Science
- CBA
 - Master's SCLM, HRM, BA
- CLA
 - BA Theatre
 - Animation Concentration (A&AH)
- COS
 - Gaming Concentration (CS)
- CBA/COE/COS
 - MS Cybersecurity
- CON
 - Early Promotion into Nursing Program

UAH

THE UNIVERSITY OF
ALABAMA IN HUNTSVILLE



Spring 2014

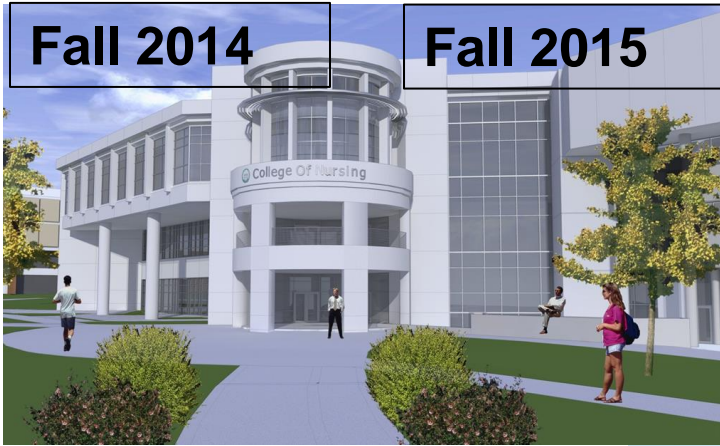

Fall 2014

Fall 2015



Fall 2014



Sum 2014



Fall 2014

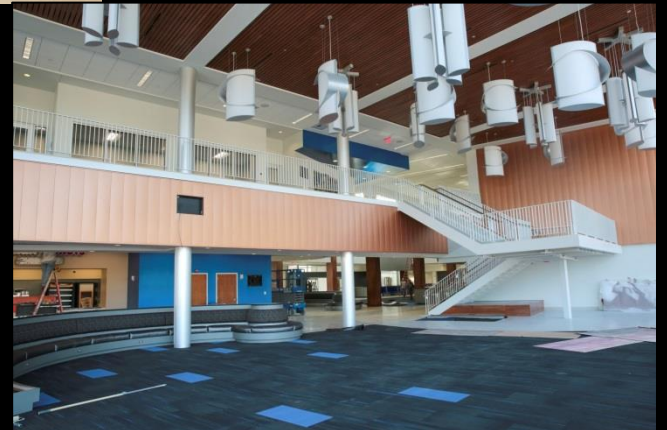

Spring 2016

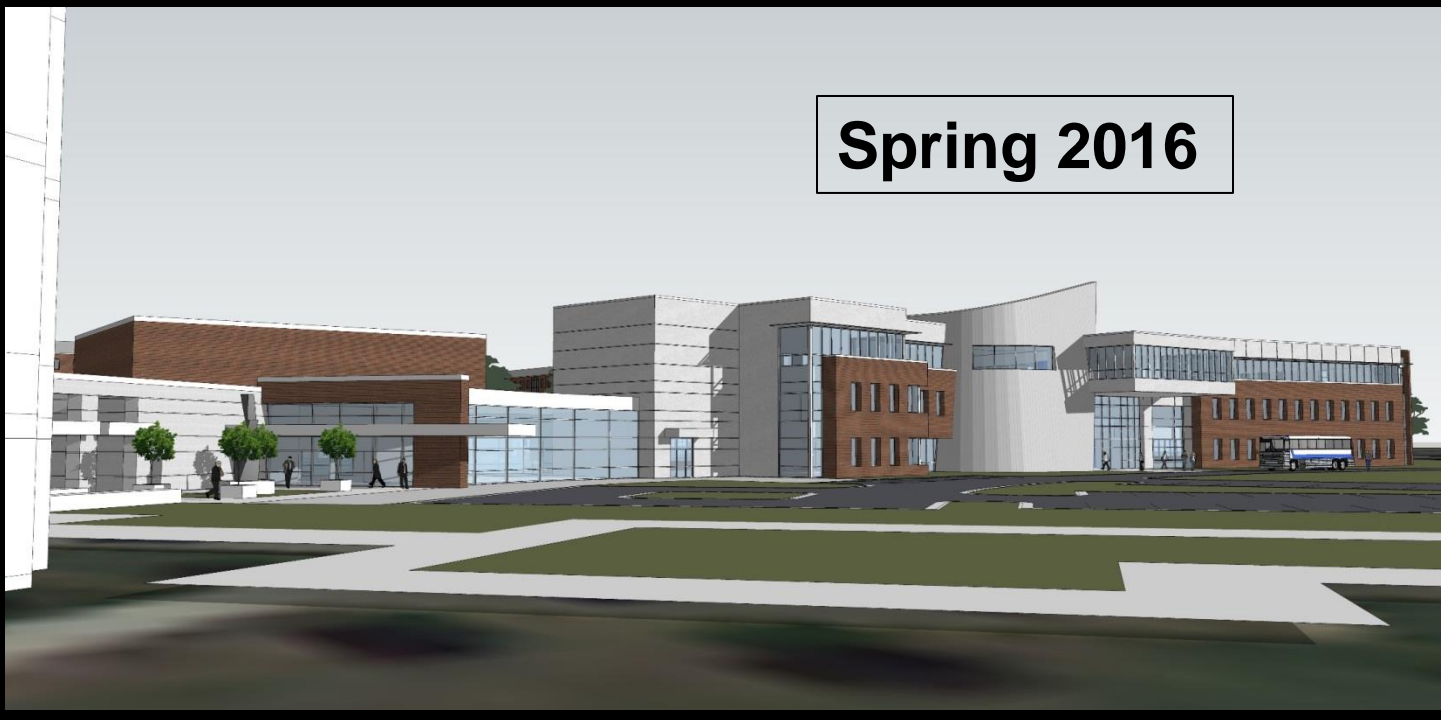

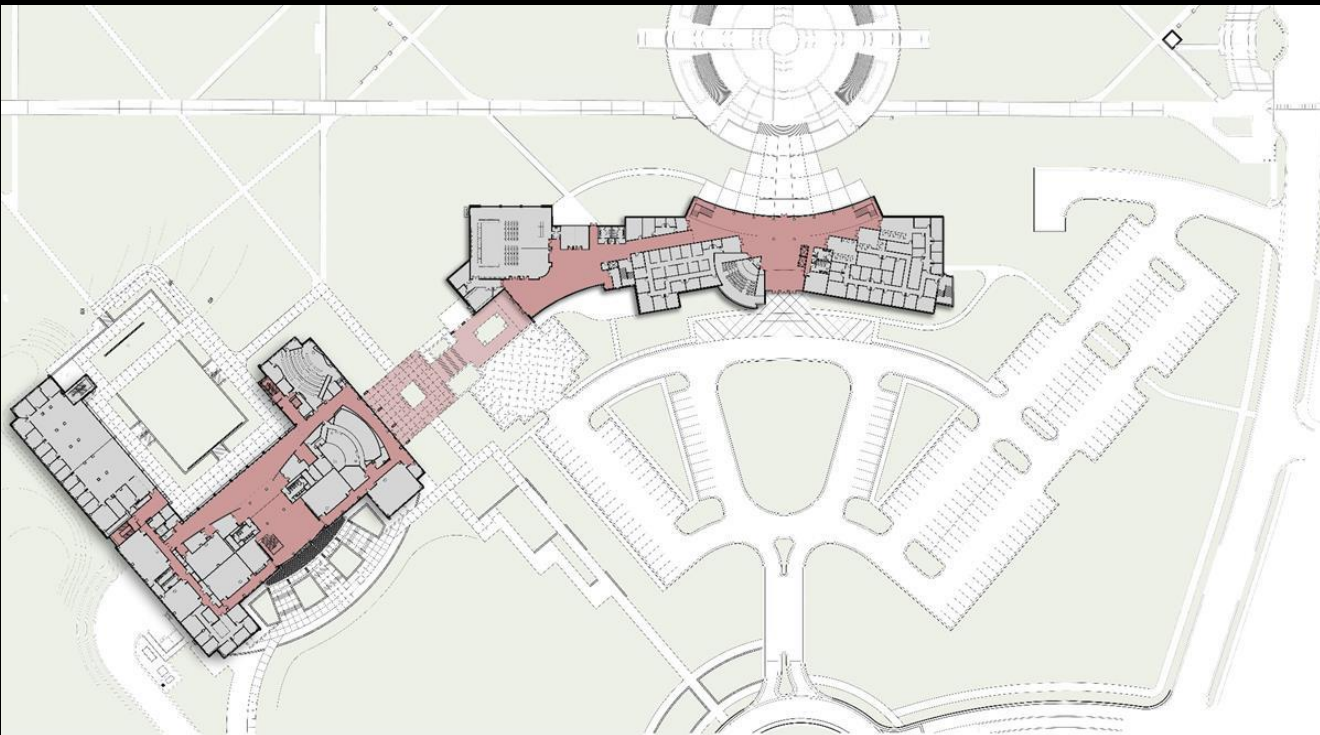



RECRUIT + RETAIN + GRADUATE

- Block Tuition
- Freshman Summer School Initiative
- Financial Aid
- Academic expansion/enhancement
- Campus improvements
- Expanded in-state & out-of-state recruitment
- Expanded AP score acceptance
- Charger Foundations
- Division of Student Affairs (VPSA)
- SACS focus on retention and graduation rates

IMPACT

- Fall 13 to Fall 14
 - Freshmen ↑11.9%
 - HSGPA 3.64→3.70
 - ACT 25.8→26.7
 - Engineering Freshmen ↑23.2%
 - Master's ↑3.7%

- Fall 14 to Fall 15 (10-20-14)
 - Freshman applications ↑104%
 - Freshman admitted ↑88%





Coming Spring 2016





**THE UNIVERSITY OF
ALABAMA IN HUNTSVILLE**



THE UNIVERSITY OF
ALABAMA IN HUNTSVILLE
